



# Graco Supply Systems

Lubrication Bulk Packages with Advanced NXT<sup>®</sup> Technology



PROVEN QUALITY. LEADING TECHNOLOGY.

# Move Large Amounts of Oil and Grease Fast!

## Dispenses up to 31 gallons of oil or 57 pounds of grease a minute

- Tested to outperform and outlast all other pumps on the market with its long-life packing design
- Intuitive, easy-to-use controls
- Best value for the money—fewer parts, faster repairs and long-lasting durability

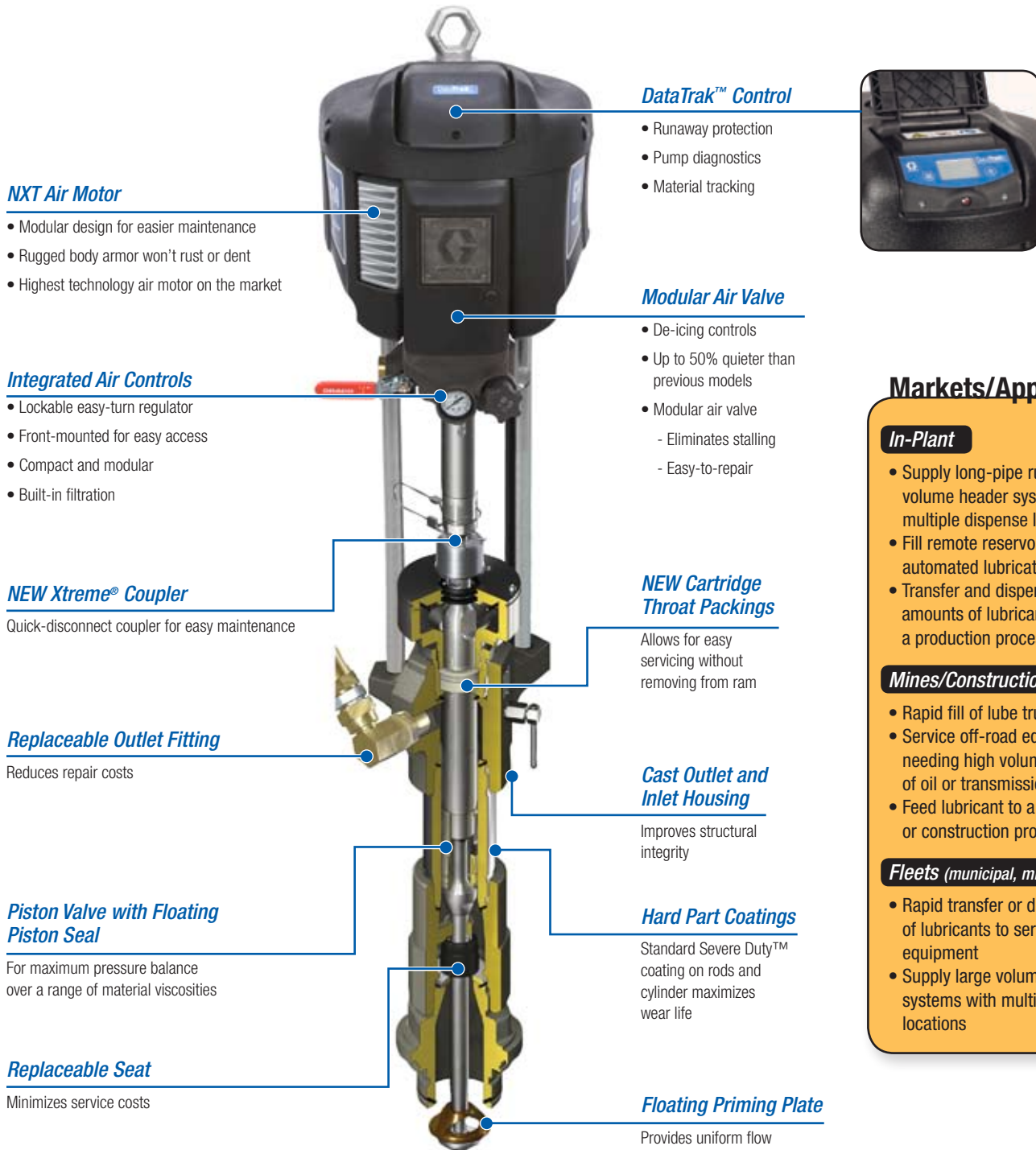

### **NXT Air Motor**

- Modular design for easier maintenance
- Rugged body armor won't rust or dent
- Highest technology air motor on the market

### **Integrated Air Controls**

- Lockable easy-turn regulator
- Front-mounted for easy access
- Compact and modular
- Built-in filtration

### **NEW Xtreme® Coupler**

Quick-disconnect coupler for easy maintenance

### **Replaceable Outlet Fitting**

Reduces repair costs

### **Piston Valve with Floating Piston Seal**

For maximum pressure balance over a range of material viscosities

### **Replaceable Seat**

Minimizes service costs

### **DataTrak™ Control**

- Runaway protection
- Pump diagnostics
- Material tracking



### **Modular Air Valve**

- De-icing controls
- Up to 50% quieter than previous models
- Modular air valve
  - Eliminates stalling
  - Easy-to-repair

### **NEW Cartridge Throat Packings**

Allows for easy servicing without removing from ram

### **Cast Outlet and Inlet Housing**

Improves structural integrity

### **Hard Part Coatings**

Standard Severe Duty™ coating on rods and cylinder maximizes wear life

### **Floating Priming Plate**

Provides uniform flow

## Markets/Applications

### **In-Plant**

- Supply long-pipe runs or large volume header systems with multiple dispense locations
- Fill remote reservoirs or feed an automated lubrication system
- Transfer and dispense large amounts of lubricant to supply a production process

### **Mines/Construction**

- Rapid fill of lube trucks
- Service off-road equipment needing high volume transfers of oil or transmission fluids
- Feed lubricant to a mine or construction process

### **Fleets (municipal, military, aviation)**

- Rapid transfer or dispense of lubricants to service fleet equipment
- Supply large volume header systems with multiple dispense locations

## What's NXT?

Innovation that boosts your productivity.

Graco NXT. It's what's next.

# DataTrak...More Control Than Ever Before

## Advanced Graco Control Architecture

### The Rules Have Changed

- Provides pump runaway protection by monitoring pump speed. DataTrak automatically shuts the pump off when material runs out or if a hose breaks.
- Tracks and displays material usage and volumetric flow, and tells you how much material is left in the drum. With an accurate, unbiased measurement of flow, DataTrak helps ensure quality control and eliminates material waste.
- Provides pump diagnostics for better maintenance. DataTrak tracks material throughput, which indicates when it's time for routine maintenance. It also provides pump lower diagnostics and lets you know whether the pump is diving in the up or down stroke—a good indication that packings or balls are starting to wear, or the pump needs to be cleaned.



### Remote Control for Maximum Convenience

- Integrated ram and pump control is easy to use and easy to see
- Intuitive electronic user interface gives the operator immediate and important operating data at the touch of a button

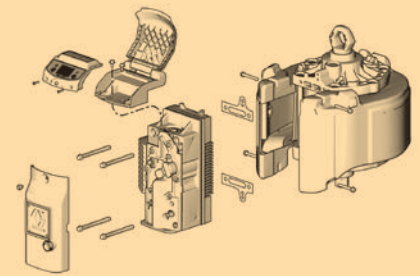

### Modular—No Special Tools Required

Graco air motors are designed with modular components so that no special tools are needed for assembly and repair.

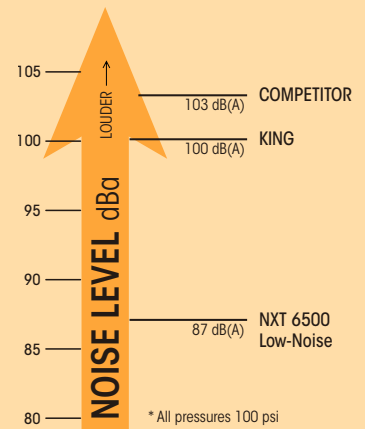

### Quiet Operation

The quiet, low-noise NXT Air Motor operates around 87 decibels, while other comparable motors operate up to 103 dB(A).

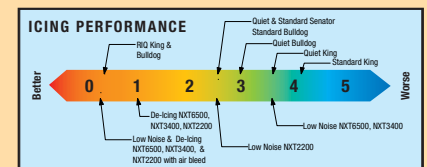

### Reduced Icing Keeps You Pumping

Frost or ice can freeze-up the pump when you're moving large volumes of oil or grease.

Graco's all new de-icing technology adds warmer ambient air to the air motor to melt any build-up.

# Check-Mate® Grease Systems

## Check-Mate Grease Pump Floor Stand Packages

		14:1	26:1	29:1	55:1	63:1	68:1	
CHECK-MATE FLOOR STAND PUMPS	PUMP SPECIFICATIONS	Package Number	247973	247976	247974	247977	247975	247978
		Mounting	Floor Stand (223952)	Floor Stand (223952)	Floor Stand (223952)	Floor Stand (223952)	Floor Stand (223952)	Floor Stand (223952)
		Pump	P14MCS	P26MCS	P29MCS	P55MCS	P63MCS	P68MCS
		Output per Cycle	500cc	500cc	250cc	250cc	100cc	200cc
		Motor Size	NXT 3400	NXT 6500	NXT 3400	NXT 6500	NXT 3400	NXT 6500
		Maximum Fluid Pressure psi (bar, Mpa)	1400 (96.5, 9.7)	2600 (179.3, 17.9)	2900 (200.0, 20.0)	5500 (379.2, 37.9)	4500 (310.3, 31.0)	5300 (356.5, 36.5)
		Maximum Air Input Pressure psi (bar, Mpa)	100 (6.9, 0.7)	100 (6.9, 0.7)	100 (6.9, 0.7)	100 (6.9, 0.7)	72 (5.0, 0.5)	78 (5.4, 0.53)
		Output at 60 CPM lbs/min (kg/min)*	57.0 (26.0)	57.0 (26.0)	28.0 (13.0)	28.0 (13.0)	11.4 (5.2)	22.8 (10.4)
	MANUALS	System Manual	312863	312863	312863	312863	312863	312863
		Pump Manual	312376	312376	312376	312376	312376	312376
		Pump Lower Manual	312375	312375	312375	312375	312375	312375
		Motor Manual	311238	311238	311238	311238	311238	311238
	OUTLET	Pump Outlet Size	1 1/2 in npt (m)	1 1/2 in npt (m)	1 in npt (f)	1 in npt (f)	3/4 in npt (m)	1 in npt (f)
		HOSES	3/4 in x 6 ft Air Hose	208610	208610	208610	208610	208610
	1 in x 6 ft Fluid Hose		115042	244657	244657	244657	244657	244657

\*Graco recommends 20 CPM or less for supply applications



## Check-Mate Grease Ram Packages

		14:1	63:1	68:1	
CHECK-MATE RAM PUMPS	PUMP SPECIFICATIONS	Package Number	247979	247980	247981
		Mounting	RAM System	RAM System	RAM System
		Pump	P14RCS	P63RCS	P68RCS
		Output per Cycle	500cc	100cc	200cc
		Motor Size	NXT 3400	NXT 3400	NXT 6500
		Maximum Fluid Pressure psi (bar, Mpa)	1400 (96.5, 9.7)	4500 (310.3, 31.0)	5300 (365.5, 36.5)
		Maximum Air Input Pressure psi (bar, Mpa)	100 (6.9, 0.7)	72 (5.0, 0.5)	78 (5.4, 0.53)
		Output at 60 CPM lbs/min (kg/min)*	57.0 (26.0)	11.4 (5.2)	22.8 (10.4)
	MANUALS	System Manual	312863	312863	312863
		Pump Manual	312376	312376	312376
		Pump Lower Manual	312375	312375	312375
		Motor Manual	311238	311238	311238
		Supply Systems Operation	312371	312371	312371
		Supply Systems Repair & Parts	312373	312373	312373
	OUTLET	Pump Outlet Size	1 1/2 in npt (m)	3/4 in npt (m)	1 in npt (f)
		HOSES	3/4 in x 6 ft Air Hose	208610	208610
1 in x 6 ft Fluid Hose	115042		244657	244657	

\*Graco recommends 20 CPM or less for supply applications



# Dura-Flo™ and High-Flo® Oil Systems

## Dura-Flo Oil Pump Packages

		6:1	10:1	12:1	12:1	23:1	
<b>DURA-FLO PUMPS</b>	<b>PUMP SPECIFICATIONS</b>	Package Number	247890	247894	247983	247891	247895
		Mounting	Wall (255143)	Wall (255143)	Wall (255143)	Wall (255143)	Wall (255143)
		Pump	P06MCK (Carbon Steel)	P10MCK (Carbon Steel)	P12MSA (Stainless Steel)	P12MCD (Carbon Steel)	P23MCD (Carbon Steel)
		Output per Cycle	1000cc	1000cc	580cc	580cc	580cc
		Output at 60 CPM gpm (lpm)*	17.4 (65.9)	17.4 (65.9)	9.2 (34.8)	9.2 (34.8)	9.2 (34.8)
		Motor Size	NXT 3400	NXT 6500	NXT 3400	NXT 3400	NXT 6500
		Maximum Fluid Pressure psi (bar, Mpa)	620 (42.7, 4.3)	1180 (81.3, 8.1)	1190 (82.1, 8.2)	1190 (82.1, 8.2)	1725 (118.9, 11.9)
		Maximum Air Input Pressure psi (bar, Mpa)	100 (6.9, 0.7)	100 (6.9, 0.7)	100 (6.9, 0.7)	100 (6.9, 0.7)	75 (5.2, 0.5)
	<b>MANUALS</b>	System Manual	312862	312862	312862	312862	312862
		Pump Manual	311833	311833	311826	311826	311826
		Pump Lower Manual	311717	311717	311825	311825	311825
		Motor Manual	311238	311238	311238	311238	311238
	<b>INLET/ OUTLET SIZE</b>	Pump Inlet Size	2 in npt (f)	2 in npt (f)	2 in npt (f)	2 in npt (f)	2 in npt (f)
		Pump Outlet Size	1 1/2 in npt (f)	1 1/2 in npt (f)	1 1/2 in npt (m)	1 1/2 in npt (m)	1 1/2 in npt (m)
	<b>HOSES</b>	3/4 in x 4 ft Air Hose	110048	110048	110048	110048	110048
		1 in x 6 ft Fluid Hose	115042	115042	115042	115042	115042

\*Graco recommends 20 CPM or less for supply applications



## High-Flo Oil Pump Packages

		3.5:1	4.5:1	6:1	6:1	
<b>HIGH-FLO PUMPS</b>	<b>PUMP SPECIFICATIONS</b>	Package Number	247888	247889	247892	247893
		Mounting	Wall (255143)	Wall (255143)	Wall (255143)	Stand (218742)
		Pump Construction Carbon Steel (C)	JC35M1	JC45M7	JC60M1	JC60M1
		Output per Cycle	2000cc	1500cc	2000cc	2000cc
		Output at 60 CPM gpm (lpm)*	31.5 (119.2)	23.2 (87.8)	31.5 (119.2)	31.5 (119.2)
		Motor Size	NXT 3400	NXT 3400	NXT 6500	NXT 6500
		Maximum Fluid Pressure psi (bar, Mpa)	350 (24.1, 2.4)	450 (31.0, 3.1)	500 (35.2, 3.4)	500 (35.2, 3.4)
		Maximum Air Input Pressure psi (bar, Mpa)	100 (6.9, 0.7)	100 (6.9, 0.7)	75 (5.2, 0.5)	75 (5.2, 0.5)
	<b>MANUALS</b>	System Manual	312862	312862	312862	312862
		Pump Manual	311211	311211	311831	311831
		Pump Lower Manual	311690	311690	311832	311832
		Motor Manual	311238	311238	311238	311238
	<b>INLET/ OUTLET SIZE</b>	Pump Inlet Size	1 1/2 in npt (f)	1 1/2 in npt (f)	2 in npt (f)	2 in npt (f)
		Pump Outlet Size	1 in npt (f)	1 in npt (f)	2 in npt (f)	2 in npt (f)
	<b>HOSES</b>	3/4 in x 4 ft Air Hose	110048	110048	110048	110048
		1 in x 6 ft Fluid Hose	115042	115042	247969	247969

\*Graco recommends 20 CPM or less for supply applications

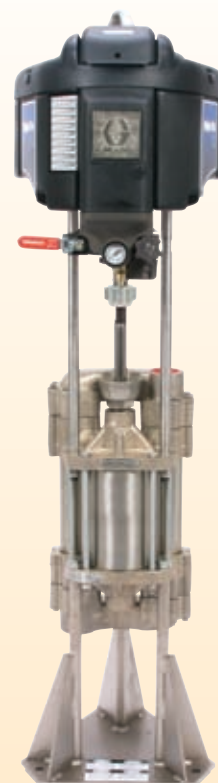



## ABOUT GRACO

### PROVEN QUALITY. LEADING TECHNOLOGY.

Founded in 1926, Graco is a world leader in fluid handling systems and components. Graco products move, measure, control, dispense and apply a wide range of fluids and viscous materials used in vehicle lubrication, commercial and industrial settings.

The company's success is based on its unwavering commitment to technical excellence, world-class manufacturing and unparalleled customer service. Working closely with qualified distributors, Graco offers systems, products and technology that set the quality standard in a wide range of fluid handling solutions. Graco provides equipment for spray finishing, protective coating, paint circulation, lubrication, and dispensing sealants and adhesives, along with power application equipment for the contractor industry. Graco's ongoing investment in fluid management and control will continue to provide innovative solutions to a diverse global market.

## GRACO LOCATIONS

### MAILING ADDRESS

P.O. Box 1441  
Minneapolis, MN 55440-1441  
Tel: 612-623-6000  
Fax: 612-623-6777

### AMERICAS

#### MINNESOTA

Worldwide Headquarters  
Graco Inc.  
88-11th Avenue N.E.  
Minneapolis, MN 55413

### EUROPE

#### BELGIUM

European Headquarters  
Graco N.V.  
Industrieterrein-Oude Bunders  
Slakweidestraat 31  
3630 Maasmechelen,  
Belgium  
Tel: 32 89 770 700  
Fax: 32 89 770 777

### ASIA PACIFIC

#### AUSTRALIA

Graco Australia Pty Ltd  
P.O. Box 558  
Level 2 / 541 Blackburn Rd.  
Mount Waverley VIC 3149  
Australia  
Tel: 61 3 9550 0848  
Fax: 61 3 9550 0816

#### CHINA

Graco Hong Kong Ltd.  
Shanghai Representative Office  
Room 118 1st Floor  
No.2 Xin Yuan Building  
No.509 Cao Bao Road  
Shanghai, P.R. China 200233  
Tel: 86 21 649 50088  
Fax: 86 21 649 50077

### INDIA

Graco Hong Kong Ltd.  
India Liaison Office  
Room 103, Level 4, Augusta Point  
Golf Course Road  
Gurgaon, Haryana, India 122001  
Tel: +91 124 435 4208  
Fax: +91 124 435 4001

### JAPAN

Graco K.K.  
1-27-12 Hayabuchi  
Tsuzuki-ku  
Yokohama City, Japan 2240025  
Tel: 81 45 593 7300  
Fax: 81 45 593 7301

### KOREA

Graco Korea Inc.  
Choheung Bank Building  
4th Floor #1599  
Gwanyang-Dong, Dongan-Ku,  
Anyang-Si, Gyunggi-Do,  
Korea 431-060  
Tel: 82(Korea) 31 476 9400  
Fax: 82(Korea) 31 476 9801

## SALES/ DISTRIBUTION/ SERVICE

Call today for product information or to request a demonstration.

**800-533-9655** or visit us at [www.graco.com](http://www.graco.com).

Graco Inc. is registered to I.S. EN ISO 9001

North America  
Customer Service  
800-533-9655  
Fax 800-533-9656